

**Imprimante thermique haute vitesse 80 mm, imprimante POS 80  
(Modèle: OCPP -88A)**

## **Caractéristiques:**

1. Apparence unique avec moule fiable;
2. Vitesse d'impression élevée jusqu'à 300 mm / seconde;
3. En option auto Cutter;
4. Cordon et communication sans fil pour les options
5. Plusieurs interfaces disponibles: USB, USB + série + LAN; et Wifi + USB, Bluetooth + USB
6. Alarme sonore et lumineuse supportée pour la cuisine;
7. Prise en charge de l'impression de plusieurs types de codes 1D et QR;
8. Prise en charge de plusieurs langues internationales
9. SDK pour Android et IOS disponible;
- dix. Tête d'imprimante fiable avec une durée de vie de 100 km;
11. Compatible avec les commandes EPSON ESC / POS.

## **paramètres:**

Méthode d'impression	Impressions thermiques
Caractère d'impression	576dots / ligne (par défaut), 512dots / ligne; Personnages : Point de chinois simplifié 24x24, bibliothèque de polices de soutien 18030, support pour le traditionnel Taiwan et HK (police complexe), Caractères ANK;
Police de caractère	A: 12 * 24 points, 1,5 (W) * 3,0 (H) mm; B: 9 * 17dots, 1.1 (W) * 2.1 (H) mm Simplifié / traditionnel: 24 * 24 points, 3.0 (B) * 3.0 (H) mm
Type de code à barres	JUPC-A / UPC-E / JAN13 (EAN13) / JAN8 (EAN8) / CODABAR / ITF / CODE39 / CODE93 / CODE128, code QR
Vitesse d'impression	250 mm / sec une et deux interface, 300 mm / s pour trois interfaces
Interface	USB, USB + série + LAN, Wifi + USB, Bluetooth + USB
Travail d'impression	Compatible avec EPSON ESC / POS commandes
pilotes	Win9X / Windows XP / Win2000 / Win2003 / Win Vista / Win 7 / Win 8 / Win8.1 / Linux, compatible avec ESPON, SDK pour Android et IOS disponible.
Largeur de papier	79,5 ± 0,5 mm (largeur d'impression 72 mm)
Diamètre du papier	83mm
Épaisseur du papier	0.06-0.08mm
Coupeur	UNEuto cutter (Optionnel)

Fiabilité d'impression	100 km	
Puissance	DC24V / 2.5A	
Température	0-45 degrés C	
Humidité de contraste	10-80%	
Dimension externe	190 *145*145(Mm)	
Poids	1,60 kg	
Commandering information	P / N	réla description
	OCPP-88A-U	USB Port, avec coupe-voiture
	OCPP -88A-url	TOISB + + Serial Lan Port, avec coupe-voiture
	OCPP -88A-W	wifi + USB Port, avec coupe-voiture
	OCPP -88A-BU	Bluetooth + USB, avec coupe-voiture
	OCPP -88A-TOI0	USB Portsans coupe-voiture
	OCPP -88A-url0	TOISB + + Serial Lan Portsans coupe-voiture
	OCPP -88A-W0	wifi + USB Portavecde coupe automatique
	OCPP -88A-BU0	Bluetooth + USB, sans cutter automatique



Unique 80mm High Speed  
POS Thermal Printer  
OCPP-88A



Product Picture



**Features:**

*Reliable with good price*

Unique appearance with reliable mould



High Printing Speed up to 300mm/second;  
Auto Cutter Optional ;  
Cord and cordless communication for options

Reliable printer head with 100km life;  
Compatible with EPSON ESC/POS  
commands.



Sound and light alarm supported  
suitable for kitchen application;



Support multi international languages;  
SDK for Android available;



Multiple interfaces available:  
USB, USB+Serial, USB+ LAN,  
USB+ Serial+ LAN; and Wifi+USB,  
Bluetooth+USB+LAN



Afrikaans	Arabic (Tunisia)	English (British)	French (Switzerland)	Latvian	Spanish (Costa Rica)
Albanian	Arabic (Yemen)	English (Canada)	German (Austria)	Lithuanian	Spanish (Dominican)
Arabic (Algeria)	Basque	English (Caribbean)	German (Liechtenstein)	Macedonian	Spanish (Ecuador)
Arabic (bahrain)	Belarus	English (Irish)	German (Luxembourg)	Polish	Spanish (Guatemala)
Arabic (Egypt)	Bulgarian	English (Jamaica)	German (Standard)	Portuguese (Brazil)	Spanish (Mexico)
Arabic (Iran)	Catalan	English (New Zealand)	German (Switzerland)	Portuguese (Portugal)	Spanish (panama)
Arabic (Jordan)	Chinese (Singapore)	English (South Africa)	Greek	Romanian	Spanish (Paraguay)
Arabic (Kuwait)	Chinese (Hongkong)	English (US)	Hebrew	Russian	Spanish (Peru)
Arabic (Lebanon)	Chinese (PRC)	Estonian	Hun	Serbian	Spanish (Uruguay)
Arabic (Libya)	Chinese (Taiwan)	Faroese	Icelandic	Slovak	Spanish (Venezuela)
Arabic (Morocco)	Croatian	Farsi	Indonesian	Slovenian	Thai Language
Arabic (Oman)	Czech	Finnish	Italian (Switzerland)	Swedish	Turkish
Arabic (Qatar)	Danish and Norwegian	French (Belgium)	Italian	Spanish (Argentina)	Ukrainian
Arabic (Saudi Arabia)	Dutch (Belgium)	French (Canada)	Japanese	Spanish (Bolivia)	Urdu
Arabic (Syria)	Dutch (standard)	French (Luxembourg)	Korean	Spanish (Chile)	Vietnamese
Arabic (UAE)	English (Australia)	French (Standard)	Vietnamese	Spanish (Colombia)	

### Power plug for option:



### How to use?

#### Connecting the printer:

- ▶ The power adapter cable connect to the printer power interface
- ▶ The interface cable connect on the printer port behind
- ▶ The cash drawer connecting cable connect to the printer's behind the cash drawer interface

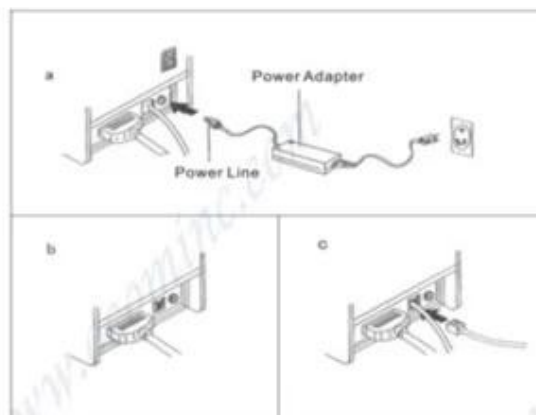



## Installation of paper roll:

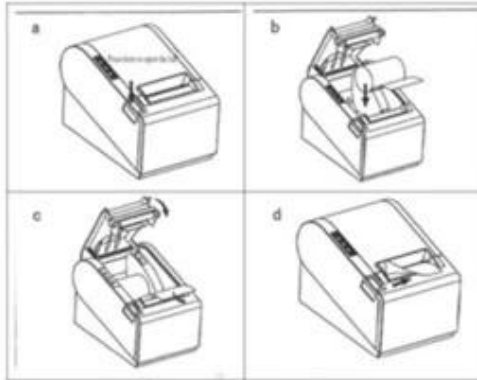

- A** Open the printer cover.
- B** Install the roller in the roll paper, and put them into the printer.
- C** Pull out some paper outside the printer and then close the printer cover.
- D** Close the top cover. Press the printer cover to avoid error position of roll paper.
- E** Tear-off the paper correctly.

## Setting the Printing Mode(DIP switches):

The DIP switches are used to set the printer to perform various functions, such as cutter mode, character set, speed, beeper, print density and etc.

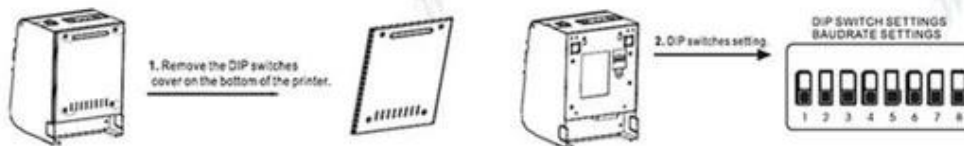

**Power indicator:**  
Turn on/off the printer

**Alarm indicator:**  
When the printer is out of paper, the cutter error occurs or printer head overheats, the ALARM indicator flashes.

**Paper indicator:**  
Both of paper indicator and error indicator are on, means paper end-user, both of paper indicator and error indicator are off, means have paper.

**FEED button:**  
Press to feed paper manually.

✓ Indicates information has been verified onsite by a certification specialist

### Test Equipment and Facilities

Verified	Machine Name	Brand & Model No.	Quantity
✓	Ageing Tester	No Information	6
✓	Withstand Voltage Tester	CC2670A	1
✓	Oscilloscope	TBS1102	1
✓	DC Power Supply	PS-305DM	6
✓	Digital Torque Meter	HP100	1
✓	Calliper	GUANGLU	2
✓	Multi-meter	VC890D	7
✓	Test Computer	No Information	13

Verified by TUV on 2013.7.15

### Certification:



### Warranty and After Sales:



- ▶ All products' warranty are not less than 12 month, some models even up to 24 months warranty.
- ▶ Spare parts will be provided for mass orders for customers' local maintenance.
- ▶ Any product found to be defective within 30 days of shipment shall be deemed Dead on Arrival (DOA). DOA products will be advance replaced and shipped via express.
- ▶ Have distributors or authorized agents in the main market who can provide local repair and replacement services.
- ▶ Professional CRM management insures fast respond for customer's enquiries and orders tracking.
- ▶ Sales with many years experience in foreign trade, proficient in foreign languages and strong sense of responsibility.
- ▶ 7\*24 hours online, responds with 12 hours in working days, and within 24 hours for rest days.

### Packing and Shipment:

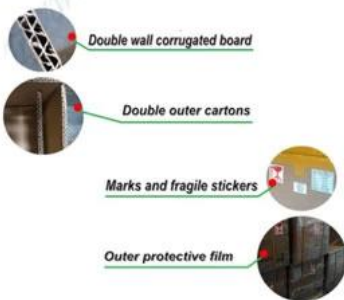

### Payment:



secure payment



AliExpress

PayPal

Trade Assurance

## Customers Reference

Over the years, OCOM keep efforts on marking "OCOM" as an internationally recognized brand, and we have established goods relationship with our customers and have friendly communication with each other.



## Contact& ENSP; NOUS

**Adresse:** 4 / F, bloc 10, parc industriel de Zhongxing, route de Chuangye, district de Nanshan, Shenzhen 518054, Chine;

**Site Internet:** [www.ocominc.com](http://www.ocominc.com), [www.posolution.com.cn](http://www.posolution.com.cn);

**Email:** [sales07@ocominc.com](mailto:sales07@ocominc.com), [sales07@ocomtech.com.cn](mailto:sales07@ocomtech.com.cn);

**Directeur commercial:** cn1000542707;

**Skype:** en direct: ocom sales07;

**MSN:** [ocomsales07@hotmail.com](mailto:ocomsales07@hotmail.com);

**QQ:** 3152989359;

**Mobile / Wechat / Whatsapp:** 0086.189.48778596;

**Tel:** 0086.755.86053207-807;

**Télécopieur:** 0086.755.86053207-868;





Phoebe Hong



## OCOM Technologies Limited

**Add:** 4/F, Block10, Zhongxing Industrial Park, Chuangye Road, Nanshan District, Shenzhen 518054, China

**Tel:** 0086.755.8605.3207 ext 807

**Fax:** 0086.755.8605.3207 ext 868

**Web:** [www.ocominc.com](http://www.ocominc.com)

**E-mail:** [sales07@ocominc.com](mailto:sales07@ocominc.com), [sales07@ocomtech.com.cn](mailto:sales07@ocomtech.com.cn)

**Skype:** [ocomsales07](https://www.skype.com/people/ocomsales07); **MSN:** [ocomsales07@hotmail.com](mailto:ocomsales07@hotmail.com)

**Ali TM:** cn1000542707; **QQ:** 3152989359

**Mobile/Wechat/Whatsapp:** 0086.18948778596



Reliable One-Stop Supplier for POS and Auto-ID Related Products