

Features:

More economics□

Built-in dual sensors ensure no paper waste when loading paper.

Easy to operate□

DHCP function make the printer plug-and-play, No more complicated IP address settings.

More durable:

10W big motor and big gear, make the service life longer .

High-end materials:

Japanese ROHM Printer head, the printing life is up to 5 0km

Smarter editing software□

I OS Android Harmony OS Windows MAC, five -terminal interoperable free editing software

Specification

General	
Model	OCBP-401DT
Material	Plastic housing
Interface	USB , USBBluetooth, USBBluetooth WIFI, USBLAN
Processor	32-bit CPU
Memory	4MB Flash Memory, 320KB RAM
Printer Head life	50 KM
Power supply	I nput □AC 100V-240V , 50-60Hz , Output □ DC 24V / 2.5 A
Accessories	Power adapter , Power cable , USB cable , Label shaft , Manual
Sensors	Label edge detection, Out of paper detection, Gap detection, Black-mark detection, Cover-open detection
Gap height	2mm Min
Black-mark height	2mm Min
Font and bar code rotation	0° , 90° , 180° , 270°
Compatible command	TSPL
Printing capability	
Printing method	Direct Thermal
Resolu tion	203 DPI
P rint speed	152mm/s Max
Print width	20-108mm
Label print length	10-250 mm
Barcode and character	

Bar-code	1D bar code: Code 39, Code 93, Code 128UCC, Code 128 subsets A, B, C, Codabar, Interleaved 2 of 5, EAN-8,EAN-13, EAN-128, UPC-A, UPC-E, EAN and UPC 2(5) digits add-on, MSI, PLESSEY, POSTNET, China POST 2D bar code: PDF417, Maxi code, Data Matrix, QR code
Font	8 alpha-numeric bitmap fonts, Windows fonts are downloadable from software
Media	
Paper type	Folded paper or roll paper, die-cut label, black mark paper
Paper width	20-118mm
Paper thickness	0.06-0.22mm
Label roll capacity	127 mm OD (outside wound)
Physical	
Dimension	232mm*180mm*152mm(LWH)
Weight	Net:1.36 kg
Package box	254*254*174mm/1.92Kg
8 in 1 carton	528*528*368mm/15.36kg
Environment	
Working temperature & humidity	0 to 4 5 degrees centigrade , 10%~80% No condensation
Storage temperature & humidity	-20 to 50 degrees centigrade , 10%~90% No condensation

Built-in Dual Sensors

no paper wastewhen loading paper



* Other Printer

Packaging accessories

SMART PRINTING



Beautiful packaging, original accessories



01 Machine 02 USB Cable 03 Thermal Paper

04 AC Adapter 05 Power Cable 06 Tube Mandrel

07 User Manual 1~3pcs depends on the interface

Printer Internal Components

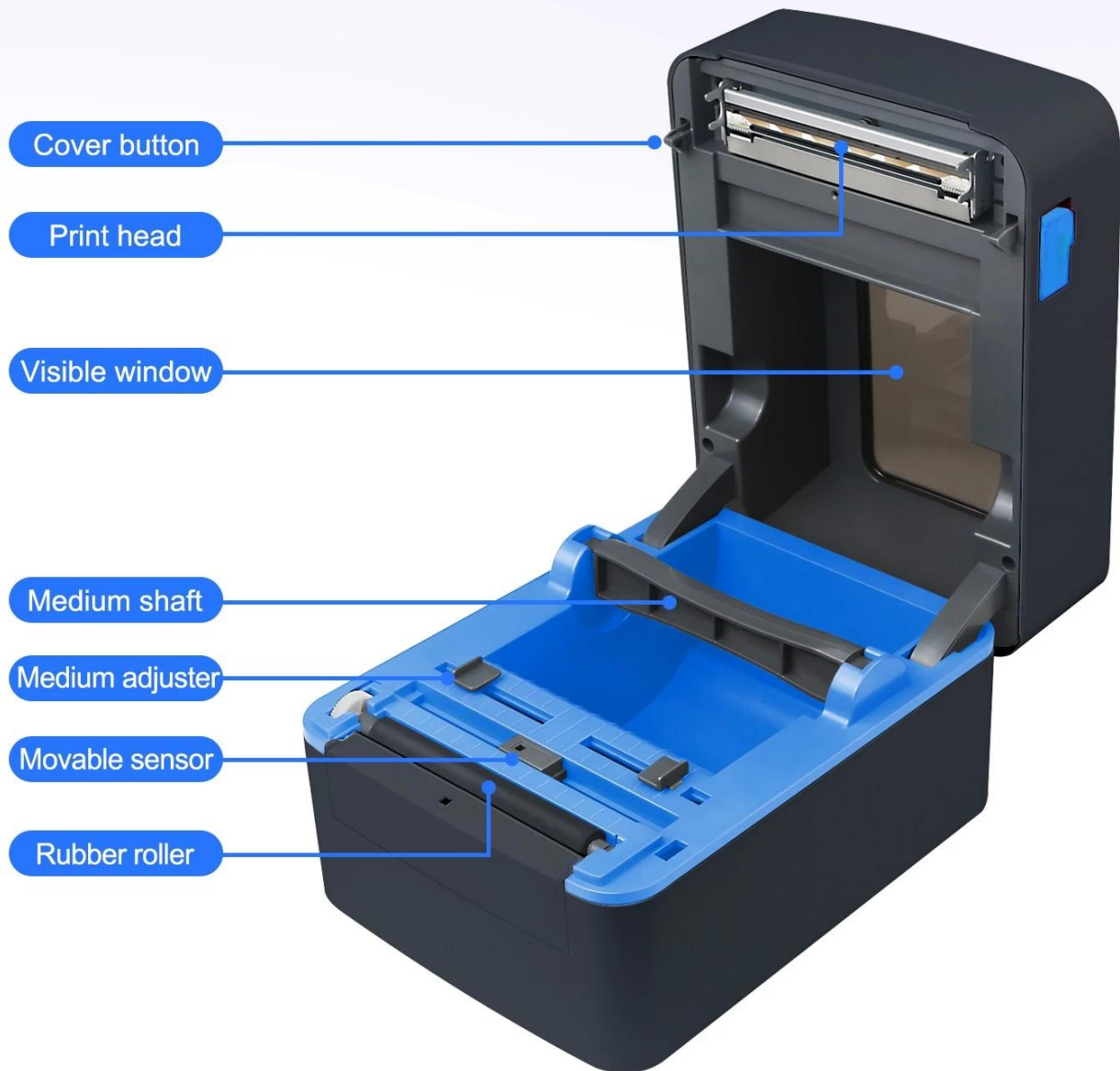

Multi-System Compatible

IOS+Android+HarmonyOS+Windows(Win xp,7,8,10,11)+MAC
five-terminal interoperable free editing software



Support Many Label Sizes

Label width from 25mm-250mm, Print width from 20-108mm

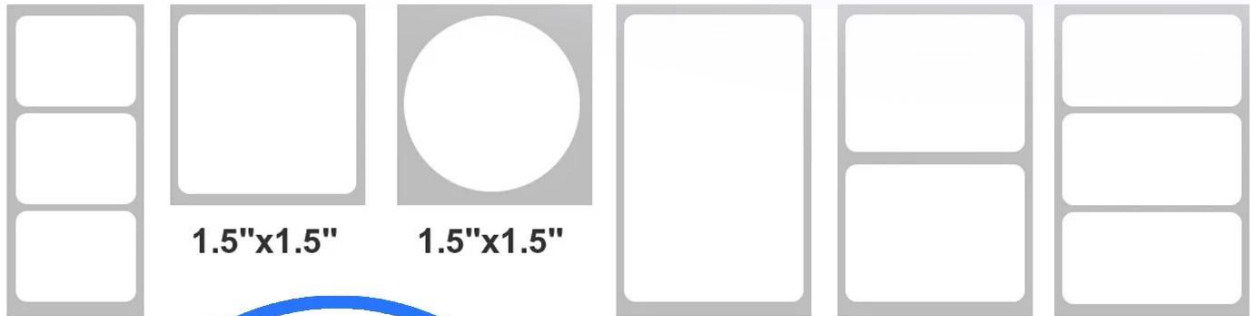

3"x2"

1.5"x1.5"

1.5"x1.5"

4"x6"

4"x3"

4"x2"



Resolution: 203 DPI



Dimensions

SMART PRINTING



232mm*180mm*152mm(L*W*H)



Manual measurement has slight errors and does not affect the use.

Thermal Barcode Label Printer

Model: OCBP-401DT



Application



Warehouse Management



Express & Logistics



Baggage Check-in



Fresh Food Supermarket



Network Information Label



Jewelry Labels

High Printing Speed

It can print 5,000 orders per hour



Printer Interface



Long Life Printhead

The service life of the print head is increased by **166%**

Other Printers  30KM Printer Head Life

OCBP-401DT  50KM Printer Head Life

