

# China, mejor impresora térmica portátil supermercado proveedor con el cortador automático

(Modelo: OCPP-802)

## Característica:

1. Loading papel fácil, resistente al agua, a prueba de aceite, a prueba de polvo
2. 230mm / s de alta velocidad imagen y caracteres de impresión, la mejor calidad de impresión y un rendimiento fiable
- Pronta impresión
3. Support ya alarma de error
4. Support sensor de punto negro, función de reimpresión
5. Compatible con EPSON ESC / POS
6. Support 256K bytes NV logodescarga almacenar e imprimir
- Impresora
7. Support función de monitor de estado, el estado de la impresora de control a cualquier hora.
8. Support conducción cajón de dinero

## Especificación:

Método de impresión	Directo térmico
Personaje El Tamaño	ANK, FontA: 12 * 24dots, FontB: 9 * 17dots
Columna capacidad:	576dots / línea O 512dots / línea
Personaje conjunto	PC347 (Europa estándar), Katakana, PC850 (multilingüe), PC860 (portugués), PC863 (canadiense-francés), PC865 (nórdico), Europa occidental, griego, hebreo, East Europe, Iran, WPC1252, PC866, Cyrillic#2, PC852, Latin2, PC858, IranII, Latvian, Arabic, PT151, 1251
Código de barras	UPC-A / UPC-E / JAN13 (EAN13) / JAN8 (EAN8) / CODABAR / ITF / CODE39 / CODE93 / CODE128
Impresión velocidad	230mm / seg
Recibir amortiguador	128k bytes
Nevada tampón de flash	256K bytes
Papel anchura	79,5 ± 0,5 mm
MCBF (la vida)	100 kilometros
Impresión mando	Compatible con ESC / POS
Efectivo control de cajón	corriente continua 12-24V / 1A
Papel espesor	0.06-0.08mm
Cortador	Cortador Manual
Rodar papel	79,5 ± 0,5 mm * φ83mm
Interfaz	Serie / paralelo / USB / LAN
Conductor	Ganar 9X / Windows ME / Windows 2000 / Win 2003 / Windows NT / Win XP / Win Vista / Win 7 / Linux
Energía suministro	DC24V / 2.5A
Energía entrada del adaptador	C.A. 110V / 220V, 50 ~ 60 Hz; salida: DC 24V / 2.5A
Dimensión	190x145x150mm
Peso	3.5kg



# 80mm Thermal Receipt Printer with Manual Cutter

## OCPP-802



### Product Picture





## Features

### **Simple but not easy**

Loading paper easy, waterproof, oil proof, dustproof



Support print prompt and error alarm  
Support black mark sensor, reprint function  
Support 256K bytes NV logo download



store and print



Compatible with EPSON ESC/POS  
and STAR



230mm/sec high speed  
printing image and characters,  
best printing quality and reliable  
performance



Support cash drawer driving



## All-round show





## Application Area

Food delivery, restaurant, Traffic Citation, Logistics,  
Transportation, Warehouse management, Delivery, Illegal  
Parking Ticket, Drugstore, Price Tag, Retail/Farm



## Parameter

<b>Printing method</b>	Direct thermal
<b>Character size</b>	ANK,FontA:12*24dots,FontB:9*17dots
<b>Column capacity:</b>	576dots/line OR 512dots/line
<b>Character set</b>	PC347 (Standard Europe)、Katakana、 PC850 (Multilingual)、PC860 (Portuguese)、 PC863 (Canadian-French)、PC865 (Nordic)、 West Europe、Greek、Hebrew、East Europe、Iran、WPC1252、PC866 (Cyrillic#2)、 PC852 (Latin2)、PC858、IranII、Latvian、Arabic、PT151 (1251)
<b>Barcode</b>	UPC-A/UPC-E/JAN13(EAN13)/JAN8(EAN8)/CODABAR/ITF/CODE39/CODE93/CO DE128
<b>Printing speed</b>	230mm/sec
<b>Receive buffer</b>	128k bytes
<b>NV flash buffer</b>	256K bytes
<b>Paper width</b>	79.5±0.5mm
<b>MCBF(life)</b>	100km
<b>Printing command</b>	Compatible with ESC/POS
<b>Cash drawer control</b>	DC 12-24V/1A
<b>Paper thickness</b>	0.06-0.08mm
<b>Cutter</b>	Manual Cutter
<b>Roll paper</b>	79.5±0.5mm* φ83mm
<b>Interface</b>	Serial/paralle/ USB/ LAN

Driver	Win 9X/Win ME/Win 2000/Win 2003/Win NT/Win XP/Win Vista/win 7/Linux
--------	---

## Paper Roll Installation



- A Open the printer cover.
- B Install the roller in the roll paper, and put them into the printer.
- C Pull out some paper outside the printer and then close the printer cover.
- D Close the top cover. Press the printer cover to avoid error position of roll paper.

### Setting the Printing Mode(DIP switches):

The DIP switches are used to set the printer to perform various functions, such as cutter mode,



character set, speed, beeper, print density and etc.

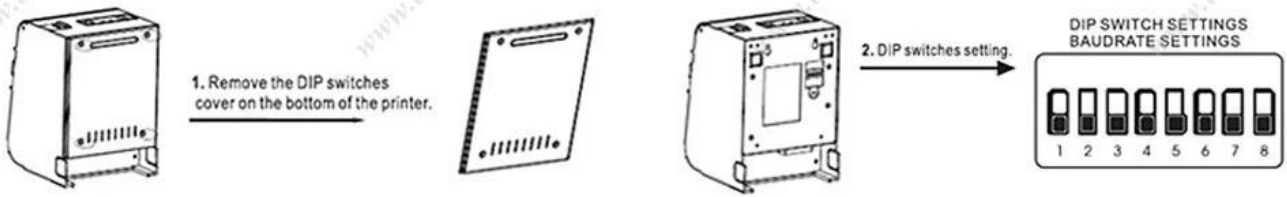

## Connection

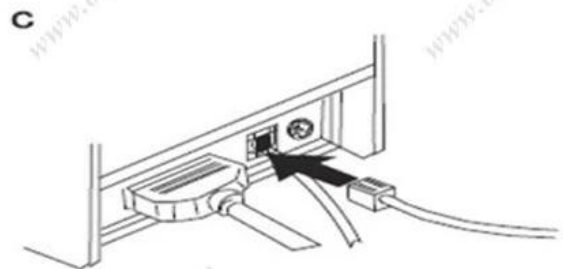
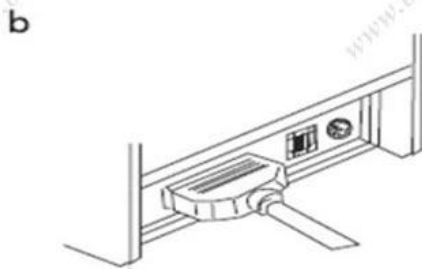
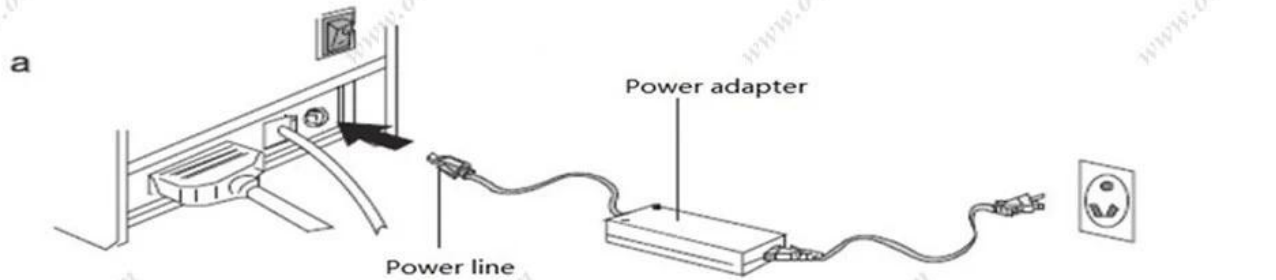

- Plug the DC cord connector into the printer's power connector..
- Plug the data cable connector into the printer's interface connector.
- Plug the drawer cable into the drawer kick-out connector on the back of

the printer next to the interface connector.

## Shipping and payment

1. Air, Sea, Express(DHL, FedEx, UPS, EMS, TNT and so on)
2. EXPRESS: around 3-7 working days to arrive
3. INTERNATIONAL AIR MAIL: usually around 2-4 days to arrive, will also depend on which destination port
4. By sea: depend on which destination port
5. T/T
6. Western Union
7. Escrow
8. L/C

## Company Profile



OCOM Technologies Limited is a professional supplier specialized in POS and Auto-ID applications. Our products portfolio covers Barcode Scanner, Barcode Printer, Thermal Printer, Dot Matrix Printer, Magnetic Card Reader, Data Collector, POS Terminal, and other IOT products.



We have FCC, CE, RoHS, and other certifications. We have sell our products to West Europe, North American, Africa, Asia-Pacific and other countries.

OCOM has professional teams including marketing, R&D, quality control, production and sales service. All of the sales representatives have 3 to 10 years experience in international trading, which help us to meet the customers' needs.

OCOM have been sticking to the quality system of ISO9001:2008. We conduct strict ISO, IEC and CCC

OCOMI have been sticking to the quality system of ISO9001:2008. we conduct strict IQC, IPQC and OQC inspection in every industrial procedure. Based on our strong capacity, the normal lead time for main products is about 3 to 7 days even for bulk order.

You can find more information of us at: [www.ocominc.com](http://www.ocominc.com),  
Together we quest for the best.

