

Κίνα καλύτερος προμηθευτής σούπερ μάρκετ φορητό θερμικό εκτυπωτή με αυτόματο κόπτη

(Μοντέλο: OCPP-802)

Χαρακτηριστικό:

- 1.ΔΟΚΙΜΕΣ ΦΟΡΤΙΣΗΣ του χαρτιού είναι εύκολη, αδιάβροχο, απόδειξη του πετρελαίου, dustproof
- 2,230 χιλιοστά / sec υψηλής ταχύτητας εκτύπωση φωτογραφιών και των χαρακτήρων, την καλύτερη ποιότητα εκτύπωσης και αξιόπιστη απόδοση
- 3.Support έγκαιρη εκτύπωση και συναγερμού σφάλματος
- 4.Support μαύρο σήμα του αισθητήρα, λειτουργία ανατύπωση
- 5.Compatible με EPSON ESC / POS
- 6.Support 256K bytes NV logo λήψη κατάσταση και εκτύπωσης
- Εκτυπωτή 7.Support λειτουργία παρακολούθησης κατάσταση, την κατάσταση του εκτυπωτή ελέγχου οποιαδήποτε στιγμή.
- 8.Support συρτάρι μετρητών οδήγησης

Προσδιορισμός:

Μέθοδος εκτύπωσης	Απευθείας θερμικός
Χαρακτήρας μέγεθος	ANK, FONTA: 12 * 24dots, FontB: 9 * 17dots
Στήλη χωρητικότητα:	576dots / γραμμή Ή 512dots / γραμμή
Χαρακτήρας σειρά	PC347 (Πρότυπο Ευρώπη), Κατακάνα, PC850 (πολύγλωσσο), PC860 (πορτογαλικά), PC863 (Canadian-γαλλικά), PC865 (Nordic), Δυτική Ευρώπη, Ελληνικά, Εβραϊκά, Ανατολή Europe[]Iran[]WPC1252[]PC866[]Cyrillic#2[]PC852 []Latin2[]PC858[]IranII[]Latvian[]Arabic[]PT151[]1251[]
Barcode	UPC-A / UPC-E / JAN13 (EAN13) / JAN8 (EAN8) / codabar / ITF / Code39 / CODE93 / Code128
Εκτύπωση ταχύτητα	230 χιλιοστών / sec
Λαμβάνω ρυθμιστής	128k bytes
NV ρυθμιστικό flash	256K bytes
Χαρτί πλάτος	79,5 ± 0,5 χιλιοστά
MCBF (ζωής)	100 χιλιόμετρα
Εκτύπωση εντολή	Σύμφωνος με ESC / POS
Μετρητά ελέγχου συρτάρι	DC 12-24V / 1A
Χαρτί πάχος	0.06-0.08mm
Κόπτης	Εγχειρίδιο κοπής
Ρολό χαρτί	79,5 ± 0,5 χιλιοστά * φ83mm
Διασύνδεση	Serial / παράλληλη / USB / LAN
Οδηγός	Νίκη 9X / ME Win / Win 2000/2003 Win / Win NT / Win XP / Win Vista / win 7 / Linux
Εξουσία προμήθεια	DC24V / 2.5A
Εξουσία εισόδου του προσαρμογέα	AC 110V / 220V, 50 ~ 60Hz? Εξόδου: DC 24V / 2.5A
Διάσταση	190x145x150mm
Βάρος	3.5kg



# 80mm Thermal Receipt Printer with Manual Cutter

## OCPP-802



### Product Picture





## Features

### **Simple but not easy**

Loading paper easy, waterproof, oil proof, dustproof



Support print prompt and error alarm  
Support black mark sensor, reprint function  
Support 256K bytes NV logo download



store and print



Compatible with EPSON ESC/POS  
and STAR



230mm/sec high speed  
printing image and characters,  
best printing quality and reliable  
performance



Support cash drawer driving



## All-round show





## Application Area

Food delivery, restaurant, Traffic Citation, Logistics,  
Transportation, Warehouse management, Delivery, Illegal  
Parking Ticket, Drugstore, Price Tag, Retail/Farm



## Parameter

<b>Printing method</b>	Direct thermal
<b>Character size</b>	ANK,FontA:12*24dots,FontB:9*17dots
<b>Column capacity:</b>	576dots/line OR 512dots/line
<b>Character set</b>	PC347 (Standard Europe)、Katakana、 PC850 (Multilingual)、PC860 (Portuguese)、 PC863 (Canadian-French)、PC865 (Nordic)、 West Europe、Greek、Hebrew、East Europe、Iran、WPC1252、PC866 (Cyrillic#2)、 PC852 (Latin2)、PC858、IranII、Latvian、Arabic、PT151 (1251)
<b>Barcode</b>	UPC-A/UPC-E/JAN13(EAN13)/JAN8(EAN8)/CODABAR/ITF/CODE39/CODE93/CO DE128
<b>Printing speed</b>	230mm/sec
<b>Receive buffer</b>	128k bytes
<b>NV flash buffer</b>	256K bytes
<b>Paper width</b>	79.5±0.5mm
<b>MCBF(life)</b>	100km
<b>Printing command</b>	Compatible with ESC/POS
<b>Cash drawer control</b>	DC 12-24V/1A
<b>Paper thickness</b>	0.06-0.08mm
<b>Cutter</b>	Manual Cutter
<b>Roll paper</b>	79.5±0.5mm* φ83mm
<b>Interface</b>	Serial/paralle/ USB/ LAN

Driver	Win 9X/Win ME/Win 2000/Win 2003/Win NT/Win XP/Win Vista/win 7/Linux
--------	---

## Paper Roll Installation



- A Open the printer cover.
- B Install the roller in the roll paper, and put them into the printer.
- C Pull out some paper outside the printer and then close the printer cover.
- D Close the top cover. Press the printer cover to avoid error position of roll paper.

### Setting the Printing Mode(DIP switches):

The DIP switches are used to set the printer to perform various functions, such as cutter mode,



character set, speed, beeper, print density and etc.

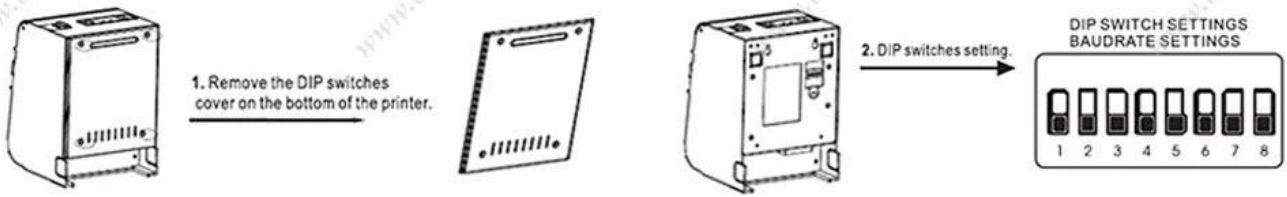

## Connection

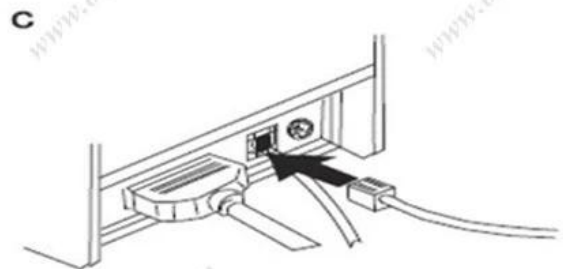
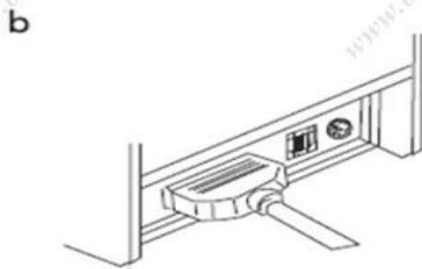
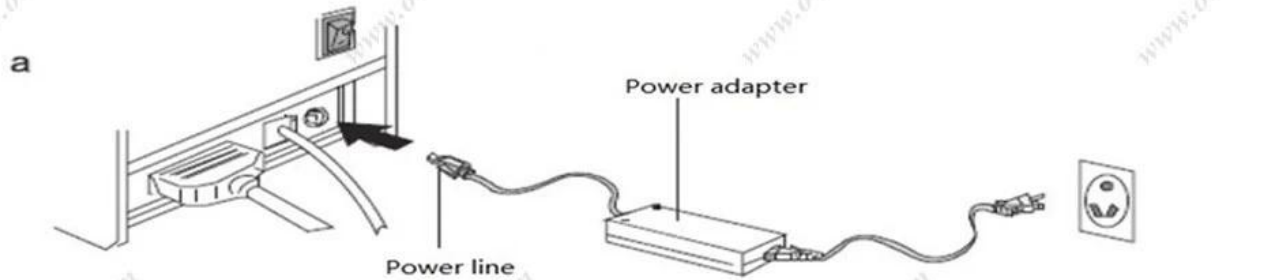

- Plug the DC cord connector into the printer's power connector..
- Plug the data cable connector into the printer's interface connector.
- Plug the drawer cable into the drawer kick-out connector on the back of

the printer next to the interface connector.

## Shipping and payment

1. Air, Sea, Express(DHL, FedEx, UPS, EMS, TNT and so on)
2. EXPRESS: around 3-7 working days to arrive
3. INTERNATIONAL AIR MAIL: usually around 2-4 days to arrive, will also depend on which destination port
4. By sea: depend on which destination port
5. T/T
6. Western Union
7. Escrow
8. L/C

## Company Profile



OCOM Technologies Limited is a professional supplier specialized in POS and Auto-ID applications. Our products portfolio covers Barcode Scanner, Barcode Printer, Thermal Printer, Dot Matrix Printer, Magnetic Card Reader, Data Collector, POS Terminal, and other IOT products.



We have FCC, CE, RoHS, and other certifications. We have sell our products to West Europe, North American, Africa, Asia-Pacific and other countries.

OCOM has professional teams including marketing, R&D, quality control, production and sales service. All of the sales representatives have 3 to 10 years experience in international trading, which help us to meet the customers' needs.

OCOM have been sticking to the quality system of ISO9001:2008. We conduct strict ISO, IEC and CCC

OCOMI have been sticking to the quality system of ISO9001:2008. we conduct strict IQC, IPQC and OQC inspection in every industrial procedure. Based on our strong capacity, the normal lead time for main products is about 3 to 7 days even for bulk order.

You can find more information of us at: [www.ocominc.com](http://www.ocominc.com),  
Together we quest for the best.

