

# Έγχρωμος εκτυπωτής παραλαβής OEM / ODM 80MM Pos με αυτόματο κόπτη

(Μοντέλο: ΑΑ00-88Α)

## Χαρακτηριστικά:

1. Μοναδική εμφάνιση με αξιόπιστο καλούπι.
2. Εκτύπωση υψηλής ταχύτητας σε ταχύτητες έως 300 mm / sec.
3. Προαιρετικός αυτόματος κόπτης.
4. Γραμμή και επιλογές Ασύρματες τηλεπικοινωνίες
5. Παρέχετε μια ποικιλία διεπαφών: USB
6. Η υποστήριξη της εφαρμογής ηχητικής ειδοποίησης είναι διαθέσιμη για την κουζίνα.
7. Υποστήριξη διαφόρων τύπων εκτύπωσης γραμμωτού κώδικα μονοδιάστατου και δισδιάστατου.
8. Υποστηρίζει μια ποικιλία διεθνών γλωσσών.
9. SDK για το Android παρέχει?
10. Αξιόπιστη ζωή κεφαλής εκτύπωσης και εκατό χιλιόμετρα.
11. Συμβατή εντολή EP SON ESC / POS.

## Παράμετροι:

|                            |  |
|----------------------------|--|
| Μέθοδοι εκτύπωσης          | Εκτύπωση με θερμική γραμμή   |
| Τυπωμένοι χαρακτήρες       | 576dots / γραμμή (προεπιλογή), 512dots / γραμμή.<br>Χαρακτήρες: Απλοποιημένο κινεζικό σημείο 24x24, υποστήριξη χαρακτήρων 18030, υποστήριξη για την Ταϊβάν και το Χονγκ Κονγκ, παραδοσιακό (σύνθετο Font), χαρακτήρας ANK. |
| Γραμματοσειρά              | A: 12 * 24dots, 1.5 (W) * 3.0 (H) mm;<br>B: 9 * 17dots, 1,1 (πλάτος) * 2,1 (H) mm<br>Απλουστευμένο / Παραδοσιακό: 24 * 24dots, 3,0 (W) * 3,0 (H) mm  |
| Τύποι γραμμωτού κώδικα     | JUPC-A / UPC-E / JAN13 (EAN13) / JAN8 (EAN8) / CODABAR / ITF / CODE39 / CODE93 / CODE128,  |
| Ταχύτητα εκτύπωσης         | 250 mm / sec ως μία μόνο διεπαφή, έως 300 mm / sec Διπλή διεπαφή και τριπλή διεπαφή  |
| Διεπαφή                    | USB, USB + σειριακό, USB + LAN, USB + Serial + LAN, Ασύρματο + USB, Bluetooth + USB + LAN  |
| Εκτύπωση εντολή            | Συμβατό με την εντολή EPSON ESC / POS  |
| Οδηγός                     | Το Win9X / Window XP / Win είναι το VISTA / WIN2000 / Win2003 / Win / Win 7 8 / win8.1 / Linux και το ESPON, SDK παρέχει συμβατότητα με το Android.  |
| Εκτύπωση πλάτος            | 79,5 ± 0,5 mm (πλάτος εκτύπωσης 72)  |
| Διάμετρος χαρτιού          | 83 mm  |
| Πάχος χαρτιού              | 0,06-0,08 mm   |
| Μαχαίρι                    | Αυτόματο κόπτης (προαιρετικό)  |
| Εκτύπωση Αξιοπιστία        | Εκατό χιλιόμετρα   |
| Εξουσία                    | DC24V / 2,5A   |
| Θερμοκρασία                | 0-45 βαθμοί Κελσίου  |
| Σε αντίθεση με την υγρασία | 10-80%   |
| Διαστάσεις                 | 190 * 145 * 145 (MM)   |
| Βάρος                      | 1,60 kg  |

|                         | P / N          | Περιγραφή  |
|-------------------------|----------------|--|
| Πληροφορίες Παραγγελίας | OCPP -88A-U    | Οι θύρες USB υποστηρίζουν αυτόματο κόπτη             |
|                         | OCPP -88A-UR   | USB + σειριακές θύρες, υποστηρίζοντας αυτόματο κόπτη |
|                         | OCPP -88A-UL   | Οι θύρες USB + LAN υποστηρίζουν αυτόματη κοπή        |
|                         | OCPP -88A-URL  | Θύρες USB + serial + LAN με αυτόματο κόπτη           |
|                         | OCPP -88A-W    | Ασύρματο + θύρα USB, αυτόματος κόπτης                |
|                         | OCPP -88A-BUL  | Bluetooth + USB + LAN, υποστηρίξτε αυτόματο κόπτη    |
|                         | OCPP -88A-U0   | Θύρα USB, χωρίς αυτόματο κόπτη                       |
|                         | OCPP-88A-UR0   | USB + serial, χωρίς αυτόματο κόπτη                   |
|                         | OCPP -88A-UL0  | Θύρα USB + LAN, χωρίς αυτόματο κόπτη                 |
|                         | OCPP -88A-URL0 | USB + σειριακή + θύρα Lan, χωρίς αυτόματο κόπτη      |
|                         | OCPP -88A-W0   | Ασύρματη θύρα + θύρα USB, χωρίς αυτόματο κόπτη       |
|                         | OCPP -88A-BUL0 | Bluetooth + USB + LAN, χωρίς αυτόματο κόπτη          |



Unique 80mm High Speed  
POS Thermal Printer  
OCPP-88A



Product Picture



**Features:**

**Reliable with good price**

**Unique appearance with reliable mould**



**High Printing Speed up to 300mm/second;  
Auto Cutter Optional ;  
Cord and cordless communication for options**

**Reliable printer head with 100km life;  
Compatible with EPSON ESC/POS  
commands.**



**Sound and light alarm supported  
suitable for kitchen application;**



**Support multi international languages;  
SDK for Android available;**



**Multiple interfaces available:  
USB, USB+Serial, USB+ LAN,  
USB+ Serial+ LAN; and Wifi+USB,  
Bluetooth+USB+LAN**



Support multiple 1D barcode and QR code printing;



## Application Area

- > Order printing for restaurant kitchen;
- > Electronic cash register POS system bill printing;
- > Electronic funds transfer (EFT) POS system bill printing;
- > Sports, postal services, civil aviation ticket printing;
- > Inquires and service system for ticket printing
- > Measuring instrument information on printing;
- > Tax, single-bill printing



## Parameter

|                      |  |  |
|----------------------|--|--|
| Printing Method      | Thermal line printing  |  |
| Printing Character   | 576dots/line (default), 512dots/line;  |  |
| Font                 | Characters : Simplified Chinese 24x24 point, support 18030 font library, support Taiwan and HK traditional (complex font), ANK characters; |  |
| Barcode Type         | A: 12*24 dots, 1.5(W)*3.0(H)mm;<br>B: 9*17 dots, 1.1(W)*2.1(H)mm<br>Simplified/Traditional : 24*24 dots, 3.0(W)*3.0(H)mm                   |  |
| Printing Speed       | JUPC-A, UPC-E, JAN13(EAN13), JAN8(EAN8), CODABAR, ITF/CODE39/CODE93/CODE128, QR code   |  |
| Interface            | 250mm/sec for a single and two interface ,300mm/sec for three interfaces   |  |
| Printing Command     | USB, USB+Serial+LAN, Wifi+USB, Bluetooth+USB   |  |
| Drivers              | Compatible with EPSON ESC/POS commands   |  |
| Paper Width          | Win9X/ Window XP /Win2000/Win2003/Win Vista/ Win 7/ Win 8/win8.1/Linux, compatible with ESPON, SDK for Android and IOS available.          |  |
| Paper Diameter       | 79.5±0.5mm( print width 72mm)  |  |
| Paper Thickness      | 83mm   |  |
| Cutter               | 0.06-0.08mm  |  |
| Printing Reliability | Auto cutter (optional)   |  |
| Power                | 100km  |  |
| Temperature          | DC24V/2.5A   |  |
| Contrast Humidity    | 0-45 degree C  |  |
| External Dimension   | 10-80%   |  |
| Weight               | 190*145*145(mm)  |  |
| Ordering information | P/N  | Description                              |
|                      | OCPP-SSA-U   | USB port, with auto cutter               |
|                      | OCPP-SSA-URL   | USB+Serial+Lan port, with auto cutter    |
|                      | OCPP-SSA-W   | Wifi+USB port, with auto cutter          |
|                      | OCPP-SSA-BU  | Bluetooth+USB, with auto-cutter          |
|                      | OCPP-SSA-U0  | USB port, without auto cutter            |
|                      | OCPP-SSA-URL0  | USB+Serial+Lan port, without auto cutter |
|                      | OCPP-SSA-W0  | Wifi+USB port, without auto cutter       |
| OCPP-SSA-BU0         | Bluetooth+USB, without auto-cutter   |  |

Supported Languages:

|                       |                      |                        |                        |                       |                      |
|-----------------------|----------------------|------------------------|------------------------|-----------------------|----------------------|
| Afrikaans             | Arabic (Tunisia)     | English (British)      | French (Switzerland)   | Latvian               | Spanish (Costa Rica) |
| Albanian              | Arabic (Yemen)       | English (Canada)       | German (Austria)       | Lithuanian            | Spanish (Dominican)  |
| Arabic (Algeria)      | Basque               | English (Caribbean)    | German (Liechtenstein) | Macedonian            | Spanish (Ecuador)    |
| Arabic (bahrain)      | Belarus              | English (Irish)        | German (Luxembourg)    | Polish                | Spanish (Guatemala)  |
| Arabic (Egypt)        | Bulgarian            | English (Jamaica)      | German (Standard)      | Portuguese (Brazil)   | Spanish (Mexico)     |
| Arabic (Iran)         | Catalan              | English (New Zealand)  | German (Switzerland)   | Portuguese (Portugal) | Spanish (panama)     |
| Arabic (Jordan)       | Chinese (Singapore)  | English (South Africa) | Greek                  | Romanian              | Spanish (Paraguay)   |
| Arabic (Kuwait)       | Chinese (Hongkong)   | English (US)           | Hebrew                 | Russian               | Spanish (Peru)       |
| Arabic (Lebanon)      | Chinese (PRC)        | Estonian               | Hun                    | Serbian               | Spanish (Uruguay)    |
| Arabic (Libya)        | Chinese (Taiwan)     | Faroese                | Icelandic              | Slovak                | Spanish (Venezuela)  |
| Arabic (Morocco)      | Croatian             | Farsi                  | Indonesian             | Slovenian             | Thai Language        |
| Arabic (Oman)         | Czech                | Finnish                | Italian (Switzerland)  | Swedish               | Turkish              |
| Arabic (Qatar)        | Danish and Norwegian | French (Belgium)       | Italian                | Spanish (Argentina)   | Ukrainian            |
| Arabic (Saudi Arabia) | Dutch (Belgium)      | French (Canada)        | Japanese               | Spanish (Bolivia)     | Urdu                 |
| Arabic (Syria)        | Dutch (standard)     | French (Luxembourg)    | Korean                 | Spanish (Chile)       | Vietnamese           |
| Arabic (UAE)          | English (Australia)  | French (Standard)      | Vietnamese             | Spanish (Colombia)    |                      |

### Power plug for option:



### How to use?

#### Connecting the printer:

- ▶ The power adapter cable connect to the printer power interface
- ▶ The interface cable connect on the printer port behind
- ▶ The cash drawer connecting cable connect to the printer's behind the cash drawer interface

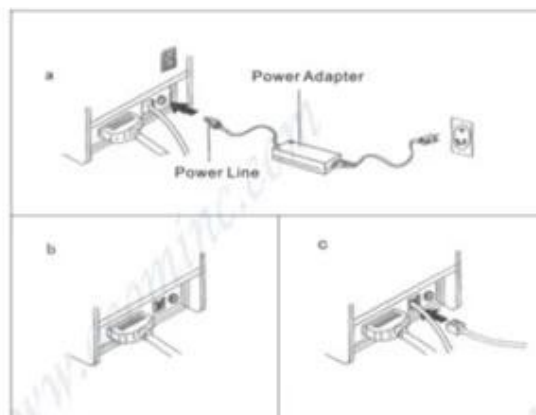

## Installation of paper roll:

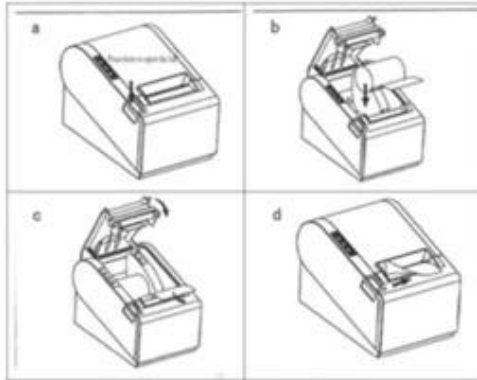

- A Open the printer cover.
- B Install the roller in the roll paper, and put them into the printer.
- C Pull out some paper outside the printer and then close the printer cover.
- D Close the top cover. Press the printer cover to avoid error position of roll paper.
- E Tear-off the paper correctly.

## Setting the Printing Mode(DIP switches):

The DIP switches are used to set the printer to perform various functions, such as cutter mode, character set, speed, beeper, print density and etc.

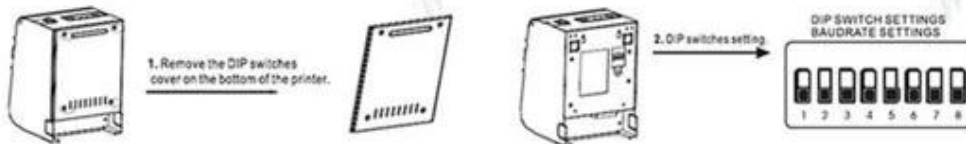

**Power indicator:**  
Turn on/off the printer

**Alarm indicator:**  
When the printer is out of paper, the cutter error occurs or printer head overheats, the ALARM indicator flashes.

**Paper indicator:**  
Both of paper indicator and error indicator are on, means paper end-user, both of paper indicator and error indicator are off, means have paper.

**FEED button:**  
Press to feed paper manually.

### Clean of printer:

When the printer has the following conditions should clean the print head:

- ❑ The printer does not clear
- ❑ The page frame lengthways of printer has some not clean
- ❑ Paper feed with a large noise

### Printer cleaning steps as follows:

- ✓ Shut off the power of printer, Open the Top Cover; If there is paper, please wipe off the paper;
- ✓ If it just finished a printing, please wait for a while until the print head cooling;
- ✓ With a soft cotton cloth dipped in ethanol (to be wrung) erase the thermal printer head thermal surface dust, stains;
- ✓ As the anhydrous ethanol evaporate completely, closed the top cover, and restart to print.

## Production Process

| No. | Production Process  | No. | Production Process   | No. | Production Process  |
|-----|---|-----|--|-----|---|
| 1   | <br>Inspection 1   | 2   | <br>Soldering     | 3   | <br>Assembling 1 |
| 4   | <br>Assembling 2   | 5   | <br>Function Test | 6   | <br>Ageing Test  |
| 7   | <br>Inspection 2 | 8   | <br>Packing 1   | 9   | <br>Packing 2  |

## Production Capacity:

✓ Indicates information has been verified onsite by a certification specialist

### Production Capacity

| Verified | Product Name                    | Production Line Capacity | Actual Units Produced(Previous Year) |
|----------|---------------------------------|--------------------------|--------------------------------------|
| ✓        | Thermal Printer                 | 40,000 Sets / Month      | 250,000 Sets                         |
| ✓        | Dot Matrix Printer              | 15,000 Sets / Month      | 10,000 Sets                          |
| ✓        | Bluetooth Printer               | 30,000 Sets / Month      | 20,000 Sets                          |
| ✓        | Barcode Scanner                 | 40,000 Sets / Month      | 20,000 Sets                          |
| ✓        | POS Machine                     | 5,000 Sets / Month       | 10,000 Sets                          |
| ✓        | Magnetic Card Reader and Writer | 45,000 Sets / Month      | 50,000 Sets                          |

Verified by TUV on 2013.7.15

## Quality Assurance:



OCOM is dedicated to providing most cost-effective products and services with highest quality that will meet customers' satisfaction.

Since the establishment, OCOM has been sticking strictly to the standard and requirements of ISO9001: 2000 in the processes of research, design, manufacturing and services. OCOM's products have passed CE, FCC, TUV, RoHs and other certifications.

We make strictly IQC, IPQC and OQC inspection per industrial standard. All the products must pass 24-48 hours aging test before shipment. Some designated models can have as long as 24 months warranty.

## Test Equipments:



✓ Indicates information has been verified onsite by a certification specialist

### Test Equipment and Facilities

| Verified | Machine Name             | Brand & Model No. | Quantity |
|----------|--------------------------|-------------------|----------|
| ✓        | Ageing Tester            | No Information    | 6        |
| ✓        | Withstand Voltage Tester | CC2670A           | 1        |
| ✓        | Oscilloscope             | TBS1102           | 1        |
| ✓        | DC Power Supply          | PS-305DM          | 6        |
| ✓        | Digital Torque Meter     | HP100             | 1        |
| ✓        | Calliper                 | GUANGLU           | 2        |
| ✓        | Multi-meter              | VC890D            | 7        |
| ✓        | Test Computer            | No Information    | 13       |

Verified by TUV on 2013.7.15

### Certification:



### Warranty and After Sales:



- ▶ All products' warranty are not less than 12 month, some models even up to 24 months warranty.
- ▶ Spare parts will be provided for mass orders for customers' local maintenance.
- ▶ Any product found to be defective within 30 days of shipment shall be deemed Dead on Arrival (DOA). DOA products will be advance replaced and shipped via express.
- ▶ Have distributors or authorized agents in the main market who can provide local repair and replacement services.
- ▶ Professional CRM management insures fast respond for customer's enquiries and orders tracking.
- ▶ Sales with many years experience in foreign trade, proficient in foreign languages and strong sense of responsibility.
- ▶ 7\*24 hours online, responds with 12 hours in working days, and within 24 hours for rest days.

### Packing and Shipment:

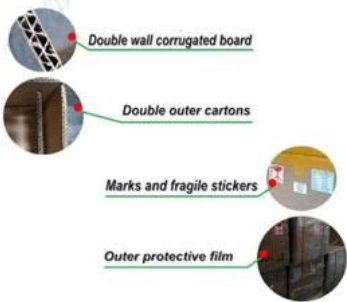

### Payment:



secure payment



Trade Assurance

## Customers Reference

Over the years, OCOM keep efforts on marking "OCOM" as an internationally recognized brand, and we have established goods relationship with our customers and have friendly communication with each other.



## Company Profile

### TRADE ASSURANCE

- 100% money refund for Late shipment & Quality problem
- Guarantee on-time delivery
- Third-party pre-shipment quality inspection (Optional)
- No transaction commission charged
- The HIGHEST assurance amount guaranteed by alibaba in the Auto-ID and POS industry .



OCOM Technologies Limited is a professional supplier specialized in POS and Auto-ID applications. Our products portfolio covers , Thermal Printer, Barcode printer, Dot Matrix Printer , Barcode Scanner, Magnetic Card Reader, Data Collector, POS Terminal, and other IOT products.



We have FCC, CE, RoHS, and other certifications. We have sell our products to West Europe, North American, Africa, Asia-Pacific and other countries.

OCOM has professional teams including marketing, R&D, quality control, production and sales service. All of the sales representatives have 3 to 10 years experience in international trading, which help us to meet the customers' needs.

OCOM have been sticking to the quality system of ISO9001:2008. We conduct strict IQC, IPQC and OQC inspection in every industrial procedure. Based on our strong capacity, the normal lead time for main products is about 3 to 7 days even for bulk order.

You can find more information of us at: [www.ocominc.com](http://www.ocominc.com),

Together we quest for the best.



**Why you choose us?**



## Contact us

**Any queries, please contact us immediately, big surprise is waiting for you.**

**Sales Center:**

Address: Unit701, Block 14, Zhongxing Industrial Park, Chuangye Road, Nanshan District, Shenzhen 518054, China

Website: [www.ocominc.com](http://www.ocominc.com) [www.possolution.com.cn](http://www.possolution.com.cn);

E-mail: [ocom@ocominc.com](mailto:ocom@ocominc.com), [info@possolution.com.cn](mailto:info@possolution.com.cn) ;

Tel: +86.755.86053207 ext 800;

Fax: +86.755.86053207 ext 868;

QQ: 2485890637, 190852203;

Wechat: szocominc, hj34924238;

Whatsapp: 008613352932860;



## Σχετικά έγγραφα:

[\\*Προσδιορισμός](#)

[\\*Εγχειρίδιο διαδικασιών](#)

[\\*Οδηγίες](#)

[\\*Οδηγός WinXP Win2000 WinVista Win8-32bit του](#)

[\\*Οδηγός Win8-64bit](#)

[\\*Linux Driver](#)

[\\*Εργαλ](#)

[\\*USB Printdemo\(Demo λογισμικού εφαρμογών\)](#)

[\\*SDK Για αντρόιντ](#)

[\\*CD Αρχεία](#)