

## Features:

### More economics□

Built-in dual sensors ensure no paper waste when loading paper.

### Easy to operate□

DHCP function make the printer plug-and-play, No more complicated IP address settings.

### More durable:

10W big motor and big gear, make the service life longer .

### High-end materials:

Japanese ROHM Printer head, the printing life is up to 5 0km

### Smarter editing software□

I OS Android Harmony OS Windows MAC, five -terminal interoperable free editing software

## Specification

General	
Model	OCBP-401DT
Material	Plastic housing
Interface	USB , USBBluetooth, USBBluetooth WIFI, USBLAN
Processor	32-bit CPU
Memory	4MB Flash Memory, 320KB RAM
Printer Head life	50 KM
Power supply	I nput □AC 100V-240V , 50-60Hz , Output □ DC 24V / 2.5 A
Accessories	Power adapter , Power cable , USB cable , Label shaft , Manual
Sensors	Label edge detection, Out of paper detection, Gap detection, Black-mark detection, Cover-open detection
Gap height	2mm Min
Black-mark height	2mm Min
Font and bar code rotation	0° , 90° , 180° , 270°
Compatible command	TSPL
Printing capability	
Printing method	Direct Thermal
Resolu tion	203 DPI
P rint speed	152mm/s Max
Print width	20-108mm
Label print length	10-250 mm
Barcode and character	

Bar-code	1D bar code: Code 39, Code 93, Code 128UCC, Code 128 subsets A, B, C, Codabar, Interleaved 2 of 5, EAN-8,EAN-13, EAN-128, UPC-A, UPC-E, EAN and UPC 2(5) digits add-on, MSI, PLESSEY, POSTNET, China POST 2D bar code: PDF417, Maxi code, Data Matrix, QR code
Font	8 alpha-numeric bitmap fonts, Windows fonts are downloadable from software
<b>Media</b>	
Paper type	Folded paper or roll paper, die-cut label, black mark paper
Paper width	20-118mm
Paper thickness	0.06-0.22mm
Label roll capacity	127 mm OD (outside wound)
<b>Physical</b>	
Dimension	232mm*180mm*152mm(LWH)
Weight	Net:1.36 kg
Package box	254*254*174mm/1.92Kg
8 in 1 carton	528*528*368mm/15.36kg
<b>Environment</b>	
Working temperature & humidity	0 to 4 5 degrees centigrade , 10%~80% No condensation
Storage temperature & humidity	-20 to 50 degrees centigrade , 10%~90% No condensation



# Built-in Dual Sensors

no paper wastewhen loading paper



\* Other Printer

# Packaging accessories

SMART PRINTING



Beautiful packaging, original accessories



01 Machine 02 USB Cable 03 Thermal Paper

04 AC Adapter 05 Power Cable 06 Tube Mandrel

07 User Manual 1~3pcs depends on the interface

# Printer Internal Components

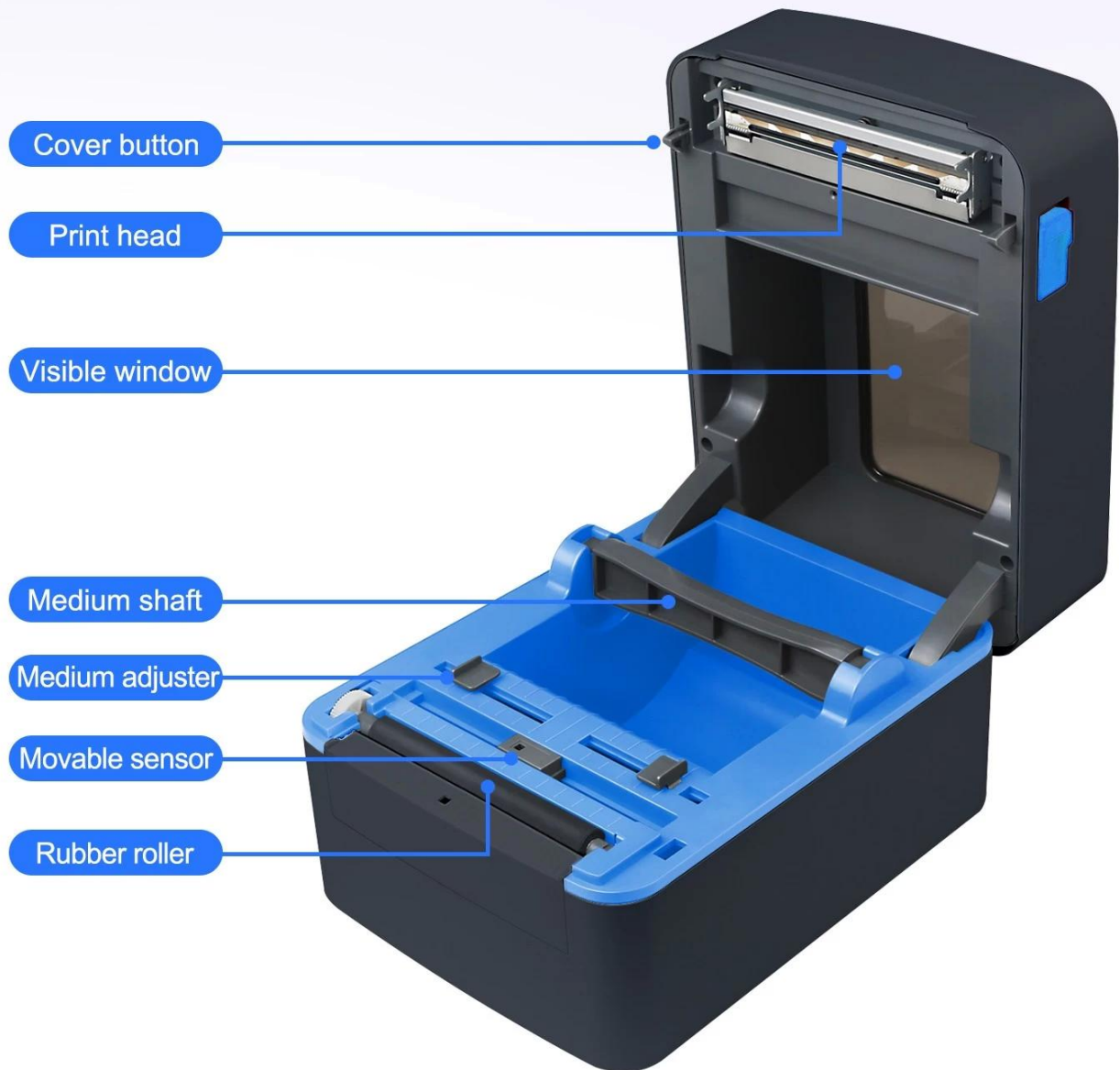

# Multi-System Compatible

IOS+Android+HarmonyOS+Windows(Win xp,7,8,10,11)+MAC  
five-terminal interoperable free editing software



# Support Many Label Sizes

Label width from 25mm-250mm, Print width from 20-108mm

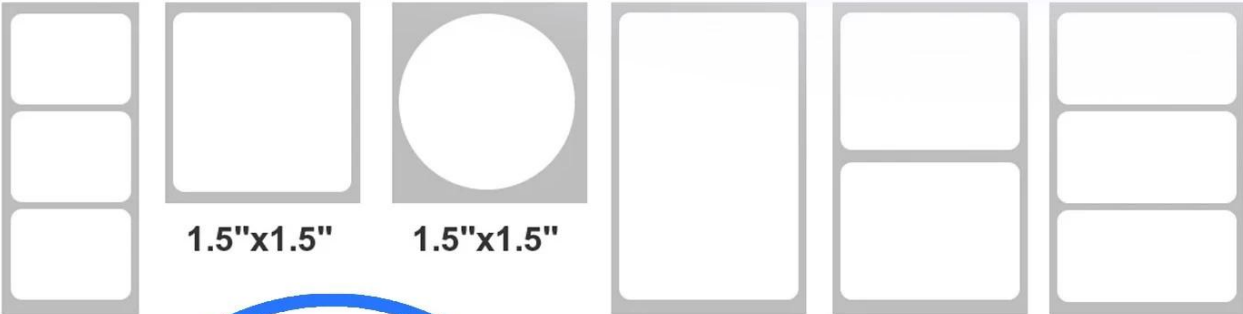

Resolution: 203 DPI





# Dimensions

SMART PRINTING



232mm\*180mm\*152mm(L\*W\*H)



Manual measurement has slight errors and does not affect the use.

# Thermal Barcode Label Printer

## Model: OCBP-401DT



# Application



Warehouse Management



Express & Logistics



Baggage Check-in



Fresh Food Supermarket



Network Information Label



Jewelry Labels

# High Printing Speed

It can print 5,000 orders per hour



# Printer Interface



# Long Life Printhead

The service life of the print head is increased by **166%**

Other Printers  30KM Printer Head Life

OCBP-401DT  50KM Printer Head Life

