

**High speed 80 mm thermal printer, POS 80 printer
(Model: OCPP -88A)**

Characteristics:

1. Unique appearance with reliable mold;
2. High print speed up to 300 mm / second;
3. Optional auto Cutter;
4. Cord and wireless communication for options
5. Multiple interfaces available: USB, USB + series-+ LAN; and Wifi + USB, Bluetooth + USB
6. Sound and light alarm supported for kitchen use;
7. Support for printing multiple 1D and QR code types;
8. Support for multiple international languages;
9. SDK for Android and IOS available;
10. Reliable printer head with a life span of 100 km;
11. Compatible with EPSON ESC / POS commands.

parameters:

Print method	Thermal line prints
Print character	576dots / line (default), 512dots / line; Characters : Simplified Chinese 24x24 point, support 18030 font library, support for traditional Taiwan and HK (complex font), ANK characters;
font	A: 12 * 24 dots, 1.5 (W) * 3.0 (H) mm; B: 9 * 17dots, 1.1 (W) * 2.1 (H) mm Simplified / traditional: 24 * 24 dots, 3.0 (B) * 3.0 (H) mm
Barcode type	JUPC-A / UPC-E / JAN13 (EAN13) / JAN8 (EAN8) / CODABAR / ITF / CODE39 / CODE93 / CODE128, QR code
Print speed	250 mm / sec a and two interface, 300 mm / sec forr three interfaces
Interface	USB,USB + series-+ LAN, Wifi + USB, Bluetooth + USB
Print job	Compatible with EPSON ESC / POS commands
drivers	Win9X / Windows XP / Win2000 / Win2003 / Win Vista / Win 7 / Win 8 / Win8.1 / Linux, compatible with ESPON, SDK for Android and IOS available.
Paper width	79.5 ± 0.5 mm (print width 72 mm)
Paper diameter	83mm
Paper thickness	0.06-0.08mm
Cutter	Auto cutter (Optional)
Print reliability	100km
power	DC24V / 2.5A
Temperature	0-45 degrees C
Contrast Humidity	10-80%
External dimension	190 *145*145(Mm)

Weight	1.60kg	
To ordering information	P / N	Ddescription
	OCPP-88A-U	USB port, with car cutter
	OCPP -88A-urI	YUSB + + Serial Lan port, with car cutter
	OCPP -88A-W	wifi + USB port, with car cutter
	OCPP -88A-BU	Bluetooth + USB, with car cutter
	OCPP -88A-YOU0	USB portwithout car cutter
	OCPP -88A-urI0	YUSB + + Serial Lan portwithout car cutter
	OCPP -88A-W0	wifi + USB portwithfrom automatic cutter
	OCPP -88A-BU0	Bluetooth + USB, without automatic cutter



Unique 80mm High Speed
POS Thermal Printer
OCPP-88A



Product Picture



Features:

Reliable with good price

Unique appearance with reliable mould



**High Printing Speed up to 300mm/second;
Auto Cutter Optional ;
Cord and cordless communication for options**

**Reliable printer head with 100km life;
Compatible with EPSON ESC/POS
commands.**



**Sound and light alarm supported
suitable for kitchen application;**



**Support multi international languages;
SDK for Android available;**



**Multiple interfaces available:
USB, USB+Serial, USB+ LAN,
USB+ Serial+ LAN; and Wifi+USB,
Bluetooth+USB+LAN**



Afrikaans	Arabic (Tunisia)	English (British)	French (Switzerland)	Latvian	Spanish (Costa Rica)
Albanian	Arabic (Yemen)	English (Canada)	German (Austria)	Lithuanian	Spanish (Dominican)
Arabic (Algeria)	Basque	English (Caribbean)	German (Liechtenstein)	Macedonian	Spanish (Ecuador)
Arabic (bahrain)	Belarus	English (Irish)	German (Luxembourg)	Polish	Spanish (Guatemala)
Arabic (Egypt)	Bulgarian	English (Jamaica)	German (Standard)	Portuguese (Brazil)	Spanish (Mexico)
Arabic (Iran)	Catalan	English (New Zealand)	German (Switzerland)	Portuguese (Portugal)	Spanish (panama)
Arabic (Jordan)	Chinese (Singapore)	English (South Africa)	Greek	Romanian	Spanish (Paraguay)
Arabic (Kuwait)	Chinese (Hongkong)	English (US)	Hebrew	Russian	Spanish (Peru)
Arabic (Lebanon)	Chinese (PRC)	Estonian	Hun	Serbian	Spanish (Uruguay)
Arabic (Libya)	Chinese (Taiwan)	Faroese	Icelandic	Slovak	Spanish (Venezuela)
Arabic (Morocco)	Croatian	Farsi	Indonesian	Slovenian	Thai Language
Arabic (Oman)	Czech	Finnish	Italian (Switzerland)	Swedish	Turkish
Arabic (Qatar)	Danish and Norwegian	French (Belgium)	Italian	Spanish (Argentina)	Ukrainian
Arabic (Saudi Arabia)	Dutch (Belgium)	French (Canada)	Japanese	Spanish (Bolivia)	Urdu
Arabic (Syria)	Dutch (standard)	French (Luxembourg)	Korean	Spanish (Chile)	Vietnamese
Arabic (UAE)	English (Australia)	French (Standard)	Vietnamese	Spanish (Colombia)	

Power plug for option:



How to use?

Connecting the printer:

- ▶ The power adapter cable connect to the printer power interface
- ▶ The interface cable connect on the printer port behind
- ▶ The cash drawer connecting cable connect to the printer's behind the cash drawer interface

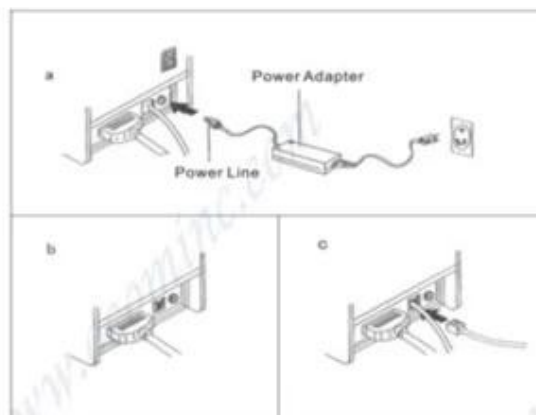

Installation of paper roll:

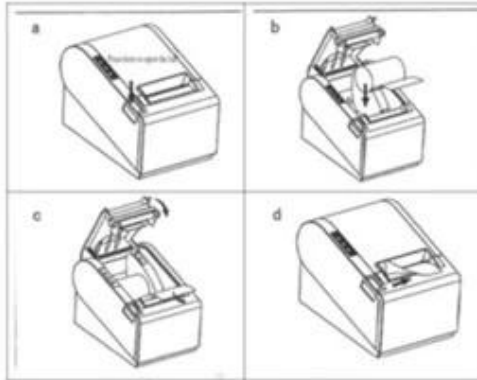

- A Open the printer cover.
- B Install the roller in the roll paper, and put them into the printer.
- C Pull out some paper outside the printer and then close the printer cover.
- D Close the top cover. Press the printer cover to avoid error position of roll paper.
- E Tear-off the paper correctly.

Setting the Printing Mode(DIP switches):

The DIP switches are used to set the printer to perform various functions, such as cutter mode, character set, speed, beeper, print density and etc.

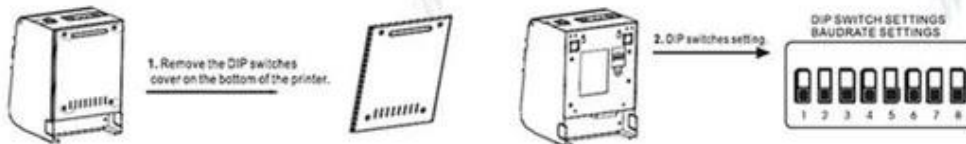

Power indicator:
Turn on/off the printer

Alarm indicator:
When the printer is out of paper, the cutter error occurs or printer head overheats, the ALARM indicator flashes.

Paper indicator:
Both of paper indicator and error indicator are on, means paper end-user, both of paper indicator and error indicator are off, means have paper.

FEED button:
Press to feed paper manually.

✓ Indicates information has been verified onsite by a certification specialist

Test Equipment and Facilities

Verified	Machine Name	Brand & Model No.	Quantity
✓	Ageing Tester	No Information	6
✓	Withstand Voltage Tester	CC2670A	1
✓	Oscilloscope	TBS1102	1
✓	DC Power Supply	PS-305DM	6
✓	Digital Torque Meter	HP100	1
✓	Calliper	GUANGLU	2
✓	Multi-meter	VC890D	7
✓	Test Computer	No Information	13

Verified by TUV on 2013.7.15

Certification:



Warranty and After Sales:



- ▶ All products' warranty are not less than 12 month, some models even up to 24 months warranty.
- ▶ Spare parts will be provided for mass orders for customers' local maintenance.
- ▶ Any product found to be defective within 30 days of shipment shall be deemed Dead on Arrival (DOA). DOA products will be advance replaced and shipped via express.
- ▶ Have distributors or authorized agents in the main market who can provide local repair and replacement services.
- ▶ Professional CRM management insures fast respond for customer's enquiries and orders tracking.
- ▶ Sales with many years experience in foreign trade, proficient in foreign languages and strong sense of responsibility.
- ▶ 7*24 hours online, responds with 12 hours in working days, and within 24 hours for rest days.

Packing and Shipment:

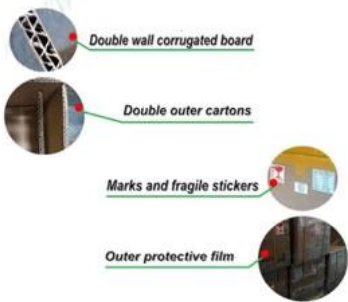

Payment:



secure payment



Trade Assurance

Customers Reference

Over the years, OCOM keep efforts on marking "OCOM" as an internationally recognized brand, and we have established goods relationship with our customers and have friendly communication with each other.



Contact& ENSP; US

Address: 4 / F, Block 10, Zhongxing Industrial Park, Chuangye Road, Nanshan District, Shenzhen 518054, China;

Website: www.ocominc.com, www.posolution.com.cn;

E-mail: sales07@ocominc.com, sales07@ocomtech.com.cn;

Trade manager: [cn1000542707](https://www.linkedin.com/in/cn1000542707);

Skype: live: ocom sales07;

MSN: ocomsales07@hotmail.com;

QQ: 3152989359;

Mobile / Wechat / Whatsapp: 0086.189.48778596;

Tel: 0086.755.86053207-807;

Fax machine: 0086.755.86053207-868;



Phoebe Hong



OCOM Technologies Limited

Add: 4/F, Block10, Zhongxing Industrial Park, Chuangye Road, Nanshan District, Shenzhen 518054, China

Tel: 0086.755.8605.3207 ext 807

Fax: 0086.755.8605.3207 ext 868

Web: www.ocominc.com

E-mail: sales07@ocominc.com, sales07@ocomtech.com.cn

Skype: [ocomsales07](https://www.skype.com/people/ocomsales07); **MSN:** ocomsales07@hotmail.com

Ali TM: [cn1000542707](https://www.ali.com); **QQ:** 3152989359

Mobile/Wechat/Whatsapp: 0086.1894877 8596



Reliable One-Stop Supplier for POS and Auto-ID Related Products